

12 Veteran's Square, Laconia



Turnkey Restaurant & Tavern

Reduced
\$1,200,000



Kevin Sullivan
Sales Associate
Weeks Commercial
603-528-3388 ext. 305 Business
603-630-3276 Cell
ksullivan@weekscommercial.com



- * 5,659 SF Main Level
- * 3,300 SF Lower Level
- * Great Visibility
- * 13,000 Cars Per Day

Weeks Commercial

350 Court St., Laconia NH 03246

www.weekscommercial.com

NOTICE: The information provided herein is believed to be accurate, but Weeks Commercial, its salespersons and employees do not warrant or guarantee its accuracy in case of error or mistake. Therefore, it is recommended that all information be verified, and that the professional advice of an attorney and/or an accountant be sought before executing any contractual agreement.

Opportunity Knocks!



Weeks Commercial is proud to offer for sale this property completely renovated and converted to showcase level restaurant/tavern/entertainment venue in the heart of the Lakes Region of NH in Downtown Laconia. Seating for 250+, ample parking, and a high end level of finish await you. 32 pull tap system featuring the best selection of craft brews in the market. Adding a brewery operation would be a perfect tie in to this turnkey business opportunity. Over 2.3 million was invested into this project, but running multiple restaurants is taking its toll on ownership, and it is time to sell. Not a detail was overlooked in the design and restoration of this 100+ year old church, converted to a beautifully appointed restaurant and tavern.



Main Floor



326 Occupancy Permit
250 Seats
26 Stools
32 Pull Draft System



Balcony & Street View



72 FT Road
Frontage

Parking On
Main St & in
City Parking
Lot

Balcony
Seats 70

2 Main
Entrances

Elevator



Kitchen



22 FT Hood
Full Sprinkler System
Walk In Cooler & Freezer

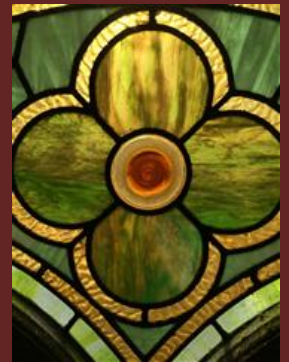

Lower Level

+



Prep Kitchen
Storage Room/Office
ADA Bathrooms
Side Entrance to Street Level
ADA Elevator Access



PROPERTY DETAILS

<u>SITE DATA</u>	
Zoning	Business Central
Traffic Count	13,000
Site Status	Available

<u>SERVICE DATA</u>	
Heating	Natural Gas/FHA
Cooling	Electric A/C Ductless Split
Water/Well	Public Water
Sewer/Septic	Public Water

<u>TAX DATA</u>	
Taxes	\$12,880
Tax Year	2016
Tax Map/Lot No.	432/225/3
Current Tax Rate/1000	\$22.20
Land Assessment	\$58,800
Building Assessment	\$521,400
Total Assessed Value	\$580,200

<u>PROPERTY DATA</u>	
Lot Size	0.15 Acres
Frontage	72 FT on Veterans Square
Number of Parking Spaces	On Street & Public Lot
Square Feet Available	5,659 SF Main Floor & 3,300 Lower Level

<u>CONSTRUCTION</u>	
Exterior	Wood Siding
Roof Type	Asphalt Shingle
Foundation	Concrete
Insulation	Yes
Year Built	1900

<u>OTHER DATA</u>	
Deed Reference	Book 2899, Page 0011

NOTICE: The information provided herein is believed to be accurate, but Weeks Commercial, its salespersons and employees do not warrant or guarantee its accuracy in case of error or mistake. Therefore, it is recommended that all information be verified, and that the professional advice of an attorney and/or an accountant be sought before executing any contractual agreement.

BALANCE SHEET

12:07 PM
11/08/16
Accrual Basis

Far-Ken LLC
Balance Sheet
As of November 8, 2016

	Nov 8, 16
ASSETS	
Current Assets	
Checking/Savings	
Operating - Pentucket	5,295.87
Total Checking/Savings	5,295.87
Accounts Receivable	
Accounts Receivable	2,071.08
Total Accounts Receivable	2,071.08
Total Current Assets	7,366.95
Fixed Assets	
Accumulated Depreciation	-131,166.00
Building Improvements	1,844,751.23
Furniture and Equipment	138,621.45
Laconia Property	320,000.00
Land Improvements	31,315.00
Total Fixed Assets	2,203,521.68
TOTAL ASSETS	2,210,888.63

NOTICE: The information provided herein is believed to be accurate, but Weeks Commercial, its salespersons and employees do not warrant or guarantee its accuracy in case of error or mistake. Therefore, it is recommended that all information be verified, and that the professional advice of an attorney and/or an accountant be sought before executing any contractual agreement.

MAP



NOTICE: The information provided herein is believed to be accurate, but Weeks Commercial, its salespersons and employees do not warrant or guarantee its accuracy in case of error or mistake. Therefore, it is recommended that all information be verified, and that the professional advice of an attorney and/or an accountant be sought before executing any contractual agreement.

TAX MAP

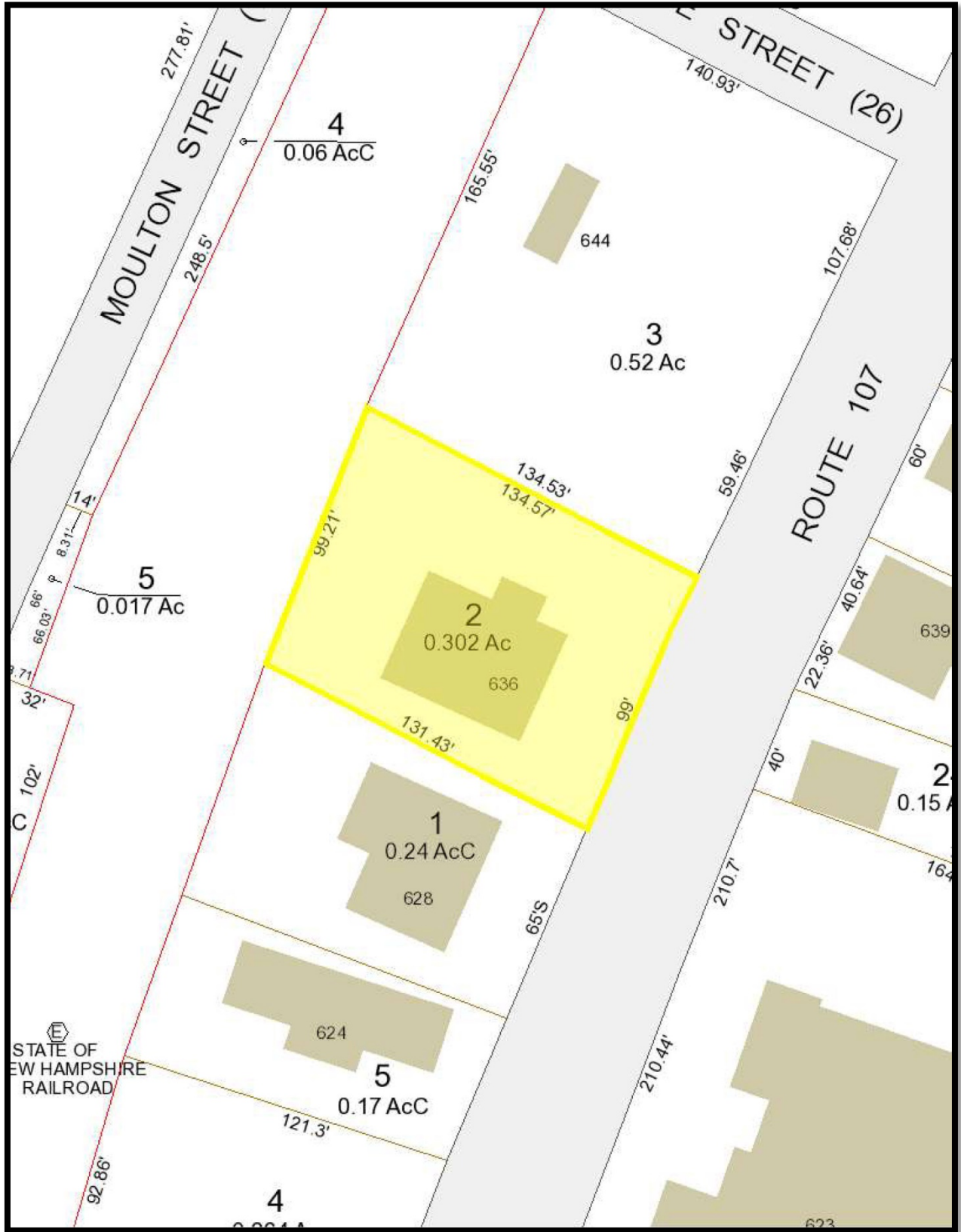

NOTICE: The information provided herein is believed to be accurate, but Weeks Commercial, its salespersons and employees do not warrant or guarantee its accuracy in case of error or mistake. Therefore, it is recommended that all information be verified, and that the professional advice of an attorney and/or an accountant be sought before executing any contractual agreement.

CITY OF LACONIA PROFILE

Laconia, NH



Community Contact	City of Laconia Scott Myers, City Manager 45 Beacon Street East Laconia, NH 03246
Telephone	(603) 527-1270
Fax	(603) 527-1292
E-mail	citymanager@city.laconia.nh.us
Web Site	www.city.laconia.nh.us
Municipal Office Hours	Monday through Friday, 8:30 am - 4:30 pm
County	Belknap
Labor Market Area	Laconia, NH Micropolitan NECTA
Tourism Region	Lakes
Planning Commission	Lakes Region
Regional Development	Belknap County Economic Development Council
Election Districts	
US Congress	District 1 (All Wards)
Executive Council	District 1 (All Wards)
State Senate	District 7 (All Wards)
State Representative	Belknap County Districts 3, 9 (All Wards)

Incorporated: 1855

Origin: The name Laconia was first used in documents granting the land between the Merrimack and Sagadahock Rivers to Captain John Mason and Sir Ferdinando Gorges. Some documents call the grant the Province of Maine, others call it the Province of Laconia, named after a region of Greece. In the 1620s explorers had hoped to follow the Piscataqua River north to Lake Champlain, in search of the great lakes and rivers of Canada told of in Indian lore. These explorers were known as the Laconia Adventurers. The town was originally a portion of Meredith and Gilford named Meredith Bridge, and was incorporated as Laconia in 1855. Incorporated as a city in 1893, Laconia includes Weirs Beach, which bears the name of primitive fishing devices discovered at the outlet of Lake Winnepesaukee.

Villages and Place Names: Lakeport, Weirs Beach

Population, Year of the First Census Taken: 1,806 residents in 1860

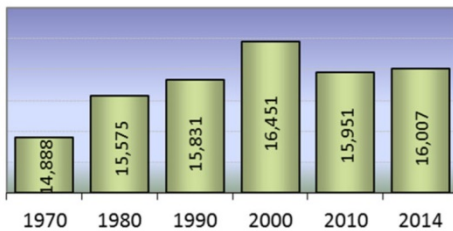

Population Trends: Population change for Laconia totaled 719 over 54 years, from 15,288 in 1960 to 16,007 in 2014. The largest decennial percent change was a five percent increase between 1970 and 1980. The 2014 Census estimate for Laconia was 16,007 residents, which ranked 15th among New Hampshire's incorporated cities and towns.

Population Density and Land Area, 2014 (US Census Bureau): 796.8 persons per square mile of land area. Laconia contains 20.1 square miles of land area and 6.0 square miles of inland water area.



Economic & Labor Market Information Bureau, NH Employment Security, August 2016. Community Response Received 5/20/2015

All information regarding the communities is from sources deemed reliable and is submitted subject to errors, omissions, modifications, and withdrawals without notice. No warranty or representation is made as to the accuracy of the information contained herein. Specific questions regarding individual cities and towns should be directed to the community contact.

NOTICE: The information provided herein is believed to be accurate, but Weeks Commercial, its salespersons and employees do not warrant or guarantee its accuracy in case of error or mistake. Therefore, it is recommended that all information be verified, and that the professional advice of an attorney and/or an accountant be sought before executing any contractual agreement.

MUNICIPAL SERVICES	
Type of Government	Manager & Council
Budget: Municipal Appropriations, 2014-2015	\$22,851,615
Budget: School Appropriations, 2014-2015	\$17,566,075
Zoning Ordinance	1948/07
Master Plan	2007
Capital Improvement Plan	Yes
Industrial Plans Reviewed By	City Planner

Boards and Commissions
 Elected: **City Council**
 Appointed: **Please visit www.city.laconia.nh.us for a list of boards & committees to which citizens may be appointed.**

Public Library **Laconia Public**

EMERGENCY SERVICES	
Police Department	Full-time
Fire Department	Municipal
Emergency Medical Service	Municipal

Nearest Hospital(s)	Distance	Staffed Beds
Lakes Region General, Laconia	Local	88

UTILITIES	
Electric Supplier	Eversource Energy; NH Electric Coop
Natural Gas Supplier	Liberty Utilities
Water Supplier	Laconia Water Works
Sanitation	Municipal
Municipal Wastewater Treatment Plant	Yes
Solid Waste Disposal	
Curbside Trash Pickup	Municipal
Pay-As-You-Throw Program	No
Recycling Program	Mandatory
Telephone Company	Fairpoint
Cellular Telephone Access	Yes
Cable Television Access	Yes
Public Access Television Station	Yes
High Speed Internet Service:	
Business	Yes
Residential	Yes

PROPERTY TAXES <i>(NH Dept. of Revenue Administration)</i>	
2015 Total Tax Rate (per \$1000 of value)	\$22.20
2015 Equalization Ratio	97.2
2015 Full Value Tax Rate (per \$1000 of value)	\$20.99
2015 Percent of Local Assessed Valuation by Property Type	
Residential Land and Buildings	83.0%
Commercial Land and Buildings	15.4%
Public Utilities, Current Use, and Other	1.6%

HOUSING <i>(ACS 2010-2014)</i>	
Total Housing Units	9,861
Single-Family Units, Detached or Attached	5,433
Units in Multiple-Family Structures:	
Two to Four Units in Structure	1,968
Five or More Units in Structure	1,988
Mobile Homes and Other Housing Units	472

DEMOGRAPHICS <i>(US Census Bureau)</i>		
Total Population	Community	County
2014	16,007	60,252
2010	15,951	60,088
2000	16,451	56,576
1990	15,831	49,294
1980	15,575	42,884
1970	14,888	32,367

Demographics, American Community Survey (ACS) 2010-2014

Population by Gender			
Male	7,433	Female	8,574

Population by Age Group	
Under age 5	821
Age 5 to 19	2,738
Age 20 to 34	2,647
Age 35 to 54	4,484
Age 55 to 64	2,476
Age 65 and over	2,841
Median Age	45.5 years

Educational Attainment, population 25 years and over	
High school graduate or higher	88.1%
Bachelor's degree or higher	24.7%

INCOME, INFLATION ADJUSTED \$ <i>(ACS 2010-2014)</i>	
Per capita income	\$28,702
Median family income	\$61,694
Median household income	\$49,925

Median Earnings, full-time, year-round workers	
Male	\$47,336
Female	\$34,357
Individuals below the poverty level	15.9%

LABOR FORCE <i>(NHES – ELMI)</i>		
Annual Average	2005	2015
Civilian labor force	8,267	7,946
Employed	7,969	7,592
Unemployed	298	354
Unemployment rate	3.6%	4.5%

EMPLOYMENT & WAGES <i>(NHES – ELMI)</i>		
Annual Average Covered Employment	2004	2014
Goods Producing Industries		
Average Employment	2,515	1,776
Average Weekly Wage	\$ 786	\$ 957
Service Providing Industries		
Average Employment	6,647	6,280
Average Weekly Wage	\$ 599	\$ 830
Total Private Industry		
Average Employment	9,162	8,056
Average Weekly Wage	\$ 651	\$ 858
Government (Federal, State, and Local)		
Average Employment	1,532	1,271
Average Weekly Wage	\$ 763	\$ 830
Total, Private Industry plus Government		
Average Employment	10,694	9,327
Average Weekly Wage	\$ 667	\$ 854

EDUCATION AND CHILD CARE

Schools students attend: **Laconia operates grades K-12** District: **SAU 30**
 Career Technology Center(s): **J. Oliva Huot Technical Center (Laconia); Winnisquam Agricultural Programs** Region: **8**

Educational Facilities (includes Charter Schools)	Elementary	Middle/Junior High	High School	Private/Parochial
Number of Schools	3	1	1	3
Grade Levels	P K 1-5	6-8	9-12	P K 1-12
Total Enrollment	977	428	586	203

Nearest Community College: **Lakes Region**
 Nearest Colleges or Universities: **Plymouth State University**

2016 NH Licensed Child Care Facilities (DHHS-Bureau of Child Care Licensing) Total Facilities: **11** Total Capacity: **664**

LARGEST BUSINESSES	PRODUCT/SERVICE	EMPLOYEES	ESTABLISHED
Aavid Engineering Corp.	Semiconductor heat sinks	620	1966
NH Ball Bearings, Inc.	Spherical bearings	478	1968
Taylor Community	Nonprofit continuing care retirement community	140	
Lewis & Sanders, Inc.	Metal tubular assemblies	130	1956
Wilcom Products, Inc	Telecommunications test equipment	85	
Baron Machine Co., Inc.	Machine parts, heat treating	70	1957
Lakes Region General Hospital	Medical care services		

Employer Information Supplied by Municipality

TRANSPORTATION (*distances estimated from city/town hall*)

Road Access	US Routes	3
	State Routes	106, 107, 11, 11A, 11B
Nearest Interstate, Exit		I-93, Exit 20
Distance		8 miles
Railroad		State owned line
Public Transportation		WTS
Nearest Public Use Airport, General Aviation		
Laconia Municipal	Runway	5,286 ft. asphalt
Lighted? Yes	Navigation Aids?	Yes
Nearest Airport with Scheduled Service		
Manchester-Boston Regional	Distance	50 miles
Number of Passenger Airlines Serving Airport		4
Driving distance to select cities:		
Manchester, NH		45 miles
Portland, Maine		85 miles
Boston, Mass.		95 miles
New York City, NY		294 miles
Montreal, Quebec		235 miles

COMMUTING TO WORK (*ACS 2010-2014*)

Workers 16 years and over	
Drove alone, car/truck/van	85.5%
Carpooled, car/truck/van	8.2%
Public transportation	0.0%
Walked	2.2%
Other means	2.1%
Worked at home	1.8%
Mean Travel Time to Work	22.1 minutes
Percent of Working Residents: ACS 2010-2014	
Working in community of residence	43.0
Commuting to another NH community	56.3
Commuting out-of-state	.7

RECREATION, ATTRACTIONS, AND EVENTS

X	Municipal Parks
	YMCA/YWCA
X	Boys Club/Girls Club
X	Golf Courses
X	Swimming: Indoor Facility
X	Swimming: Outdoor Facility
	Tennis Courts: Indoor Facility
X	Tennis Courts: Outdoor Facility
X	Ice Skating Rink: Indoor Facility
X	Bowling Facilities
	Museums
X	Cinemas
	Performing Arts Facilities
X	Tourist Attractions
X	Youth Organizations (i.e., Scouts, 4-H)
X	Youth Sports: Baseball
X	Youth Sports: Soccer
X	Youth Sports: Football
X	Youth Sports: Basketball
X	Youth Sports: Hockey
X	Campgrounds
X	Fishing/Hunting
X	Boating/Marinas
X	Snowmobile Trails
X	Bicycle Trails
X	Cross Country Skiing
X	Beach or Waterfront Recreation Area
X	Overnight or Day Camps
	Nearest Ski Area(s): Gunstock
	Other: Mount Washington Cruises; Weirs Beach; Scenic Railroad; Prescott Farm Audubon Center; Laconia Motorcycle Week; Multicultural Day; Pumpkin Festival; NH Coffee Festival

Economic & Labor Market Information Bureau, NH Employment Security, August 2016. Community Response Received **5/20/2015**

NOTICE: The information provided herein is believed to be accurate, but Weeks Commercial, its salespersons and employees do not warrant or guarantee its accuracy in case of error or mistake. Therefore, it is recommended that all information be verified, and that the professional advice of an attorney and/or an accountant be sought before executing any contractual agreement.

PERMITTED USES

ZONING

235 Attachment 2

City of Laconia Table I

Table of Permitted Uses

[Amended 12-8-1997 by Ord. No. 12.97.12; 10-26-1998 by Ord. No. 08.98.08; 5-22-2000 by Ord. No. 05.2000.05; 8-13-2001 by Ord. No. 05.2001.05; 10-22-2007 by Ord. No. 13.2007.13; 1-28-2008 by Ord. No. 01.2008.01]

RR1	RR2	RS	SFR	RG	RA	RESIDENTIAL USES	P	CR	DR	BC	C	BCI	IP	I	AI
C	C	C	C	C	C	Cluster subdivision - conventional housing	N	C	P	N	N	N	N	N	N
N	N	N	N	N	N	Combined dwelling unit(s)/business(es)	P	P	P	P	P	P	N	N	N
C	C	C	C	N	N	Manufactured housing park	N	C	N	N	N	N	N	N	N
P	P	P	P	P	P	Manufactured housing as emergency housing	P	P	N	P	P	P	P	P	P
N	N	N	P	P	P	Manufactured housing park	N	P	N	N	N	N	N	N	N
C	C	C	C	N	N	Manufactured subdivision	N	C	N	N	N	N	N	N	N
N	N	N	E	E	P	Multifamily dwelling	E	P	P	E	N	E	N	N	N
P	P	P	P	P	P	Single-family	P	P	P	P	P	P	N	N	N
N	N	N	P	P	P	Two-family dwelling	P	P	P	P	P	P	N	N	N
RR1	RR2	RS	SFR	RG	RA	RESIDENTIAL, ACCESSORY USES	P	CR	DR	BC	C	BCI	IP	I	AI
P	P	P	N	N	N	Accessory apartment	N	N	P	N	N	N	N	N	N
P	P	P	P	P	P	Building	P	P	P	P	P	P	N	N	N
P	P	P	P	P	P	Home occupation	P	P	P	P	P	P	N	N	N
P	P	E	E	N	N	Greenhouse	N	N	N	N	N	N	N	N	N
E	E	N	N	N	N	Non-pets, kennels	N	E	N	E	E	E	N	N	N

P - Permitted, E - Special Exception, C - Conditional Use Permit, N - Not Permitted, * - Special provisions in district, see Article VII.

RR1-Rural Residential 1
RR2-Rural Residential 2
RS-Residential Single Family
SFR-Shorefront Residential
RG-Residential General

RA-Residential Apartment
P-Professional
BC-Business Central
BCI-Business Central Industrial
C-Commercial

DR-Downtown Riverfront
CR-Commercial Resort
IP-Industrial Park
I-Industrial
AI-Airport Industrial

LACONIA CODE

Table I
Table of Permitted Uses
City of Laconia

RR1	RR2	RS	SFR	RG	RA	RESIDENTIAL, ACCESSORY USES (continued)	P	CR	DR	BC	C	BCI	IP	I	AI
P	P	P	P	P	P	Outdoor storage	P	P	N	P	P	P	N	N	N
P	P	E	P	P	P	Road side stand	P	P	N	P	P	P	N	N	N
P	P	P	P	P	P	Roomers, less than three	P	P	P	P	P	P	N	N	N
P	P	P	P	P	P	Shelter, emergency	P	P	N	P	P	P	P	P	P
P	P	P	E	N	N	Stable	N	E	N	N	N	N	N	N	N
P	P	P	P	P	P	Storage of travel trailers, campers, boats	P	P	N	P	P	P	N	N	N
P	P	P	P	P	P	Swimming pool	P	P	P	P	P	P	N	N	N
P	P	P	P	P	P	Yard sales	P	P	P	P	P	P	N	N	N
RR1	RR2	RS	SFR	RG	RA	RESIDENTIAL - SPECIAL SERVICE	P	CR	DR	BC	C	BCI	IP	I	AI
N	N	E	P	E	E	Assisted living facility	E	P	N	E	N	E	N	N	N
C	C	C	C	C	C	Bed-and-breakfast	C	C	P	P	P	P	N	N	N
N	N	N	P	E	E	Boarding/rooming/lodging house	E	P	E	E	E	E	N	N	N
E	E	E	E	P	P	Dormitory	N	E	C	N	E	N	N	N	E
N	N	N	N	P	E	Emergency shelter/housing	P	E	P	E	E	E	N	N	N
N	N	N	N	E	P	Transitional housing	E	N	P	E	N	E	N	N	N

P - Permitted, E - Special Exception, C - Conditional Use Permit, N - Not Permitted, * - Special provisions in district, see Article VII.

RR1-Rural Residential 1
RR2-Rural Residential 2
RS-Residential Single Family
SFR-Shorefront Residential
RG-Residential General

RA-Residential Apartment
P-Professional
BC-Business Central
BCI-Business Central Industrial
C-Commercial

DR-Downtown Riverfront
CR-Commercial Resort
IP-Industrial Park
I-Industrial
AI-Airport Industrial

**Table I
Table of Permitted Uses
City of Laconia**

RR1	RR2	RS	SFR	RG	RA	EDUCATION/CULTURAL USES	P	CR	DR	BC	C	BCI	IP	I	AI
E	E	E	E	N	N	Library/museums/gallery	P	P	P	P	P	P	N	N	N
E	E	E	E	E	E	Preschool/kindergarten	P	E	N	N	E	N	E	E	E
E	E	E	E	N	N	School, trade/vocational	P	E	C*	P	P	P	E	E	E
E	E	E	E	P	P	School, college/university/community college	N	E	C	N	E	N	N	N	E
E	E	E	E	P	P	School, elementary/secondary	N	E	N	N	E	N	N	N	E
RR1	RR2	RS	SFR	RG	RA	BUSINESS	P	CR	DR	BC	C	BCI	IP	I	AI
N	N	N	N	N	N	Eating and drinking place	P	P	P	P	P	P	E	E	E
N	N	N	N	N	N	Flea/farmer's market	E	P	P*	P	P	P	N	N	N
E	E	E	P	E	E	Neighborhood store	E	P	P	P	N	P	E	E	E
N	N	N	N	N	N	Retail sales	E	P	P	P	P	P	N	N	E
N	N	N	N	N	N	Sexually oriented business	N	P	N	N	P	N	N	N	N
N	N	N	N	N	N	Shopping center/mall	N	P	P	P	P	P	N	N	N
RR1	RR2	RS	SFR	RG	RA	SERVICE	P	CR	DR	BC	C	BCI	IP	I	AI
E	E	E	E	E	E	Artist/craftsman studio	P	P	P	P	P	P	N	N	N
C	C	C	C	C	C	Day care/day nursery	C	C	C	C	C	C	C	C	C
N	N	N	N	N	N	Equipment/appliance repair/service	N	P	N	P	P	P	N	E	E
N	N	N	N	N	N	Financial institution or business office	P	P	P	P	P	P	P	P	P
N	N	N	N	E	E	Funeral establishment - mortuary	P	N	N	P	P	P	N	N	N

P - Permitted, E - Special Exception, C - Conditional Use Permit, N - Not Permitted, * - Special provisions in district, see Article VII.

RR1-Rural Residential 1
RR2-Rural Residential 2
RS-Residential Single Family
SFR-Shorefront Residential
RG-Residential General

RA-Residential Apartment
P-Professional
BC-Business Central
BCI-Business Central Industrial
C-Commercial

DR-Downtown Riverfront
CR-Commercial Resort
IP-Industrial Park
I-Industrial
AI-Airport Industrial

LACONIA CODE

**Table I
Table of Permitted Uses
City of Laconia**

RR1	RR2	RS	SFR	RG	RA	SERVICE (continued)	P	CR	DR	BC	C	BCI	IP	I	AI
N	N	N	N	N	N	Hospital/health care facility	P	P	N	P	P	P	P	P	P
N	N	N	P	N	N	Hotel/motel/inn	E	P	P	P	P	P	N	N	E
N	N	N	N	E	E	Laundromat	P	P	N	P	P	P	P	P	P
N	N	N	N	E	E	Personal service shop	P	P	P	P	P	P	N	N	E
N	N	N	N	N	N	Professional office	P	P	P	P	P	P	P	P	P
N	N	N	N	N	N	Trades shop/repair	E	E	N	P	P	P	N	N	P
E	E	N	N	N	N	Veterinary/kennel/comm. breeding	E	E	N	P	P	P	N	N	N
RR1	RR2	RS	SFR	RG	RA	RECREATION/SPORTS/ENTERTAINMENT USES	P	CR	DR	BC	C	BCI	IP	I	AI
N	N	N	N	N	N	Amusement arcade	N	P	P*	P	P	P	N	N	E
N	N	N	N	N	N	Amusement park	N	P	N	N	E	N	N	N	N
C	C	C	N	N	N	Arts center	C	P	P	P	P	P	N	N	N
E	E	N	E	N	N	Campground, RV/tent	N	P	N	N	N	N	N	N	N
N	N	E	E	N	N	Conference center	N	P	P	P	P	P	N	N	N
C	C	C	N	N	N	Equestrian stable/center	N	C	N	N	N	N	N	N	N
N	N	N	N	N	N	Indoor recreational facility	N	P	P	P	P	P	P	P	P
N	N	N	N	N	N	Movie theater, including drive-in	N	P	P*	P	P	P	N	N	N
N	N	N	N	N	N	Nightclub/dance hall	N	P	P	P	P	P	N	N	N

P - Permitted, E - Special Exception, C - Conditional Use Permit, N - Not Permitted, * - Special provisions in district, see Article VII.

RR1-Rural Residential 1
RR2-Rural Residential 2
RS-Residential Single Family
SFR-Shorefront Residential
RG-Residential General

RA-Residential Apartment
P-Professional
BC-Business Central
BCI-Business Central Industrial
C-Commercial

DR-Downtown Riverfront
CR-Commercial Resort
IP-Industrial Park
I-Industrial
AI-Airport Industrial

NOTICE: The information provided herein is believed to be accurate, but Weeks Commercial, its salespersons and employees do not warrant or guarantee its accuracy in case of error or mistake. Therefore, it is recommended that all information be verified, and that the professional advice of an attorney and/or an accountant be sought before executing any contractual agreement.

ZONING

Table I
Table of Permitted Uses
City of Laconia

RR1	RR2	RS	SFR	RG	RA	RECREATION/SPORTS/ENTERTAINMENT USES (continued)						P	CR	DR	BC	C	BCI	IP	I	AI	
E	E	E	E	N	N	Outdoor recreational facility						N	P	N	E	P	E	P	P	N	N
N	N	N	N	N	N	Private club ¹						E	P	P	P	P	P	N	N	N	N
¹ [NOTE: Permitted as an accessory use to other permitted uses in this category]																					
RR1	RR2	RS	SFR	RG	RA	WATER-RELATED/DEPENDENT USES						P	CR	DR	BC	C	BCI	IP	I	AI	
E	N	N	P	N	N	Commercial beach						N	P	N	N	N	N	N	N	N	N
N	N	N	N	N	N	Dry slips						N	C	N	N	C	N	C	P	P	
E	N	N	E	N	N	Marina/yacht club						N	C	C	N	C	C	N	C	N	
N	N	N	N	N	N	Watercraft long term storage						N	C	N	N	C	N	P	P	P	
E	N	N	E	N	N	Marine vehicle sales and service						N	P	C*	E	P	P	N	P	N	
E	N	N	P	N	N	Watercraft launch/rental						N	P	C*	P	P	P	N	P	N	
N	N	N	N	N	N	Watercraft repair/building						N	P	N	N	P	P	P	P	P	

P - Permitted, E - Special Exception, C - Conditional Use Permit, N - Not Permitted, * - Special provisions in district, see Article VII.

RR1-Rural Residential 1
RR2-Rural Residential 2
RS-Residential Single Family
SFR-Shorefront Residential
RG-Residential General

RA-Residential Apartment
P-Professional
BC-Business Central
BCI-Business Central Industrial
C-Commercial

DR-Downtown Riverfront
CR-Commercial Resort
IP-Industrial Park
I-Industrial
AI-Airport Industrial

LACONIA CODE

Table I
Table of Permitted Uses
City of Laconia

RR1	RR2	RS	SFR	RG	RA	COMMERCIAL AND INDUSTRIAL						P	CR	DR	BC	C	BCI	IP	I	AI	
N	N	N	N	N	N	Commercial printing/photographic processing						N	E	N	P	P	P	P	P	P	
N	N	N	N	N	N	Dry cleaning establishment						N	N	N	P	P	P	P	P	P	
N	N	N	N	N	N	Fuel, wholesale/bulk storage and sales						N	N	N	E	E	E	P	P	P	
N	N	N	N	N	N	Indoor storage, self-service						E	P	N	P	P	P	P	P	P	
N	N	N	N	N	N	Lumber yard/construction yard						N	N	N	E	E	E	P	P	N	
N	N	N	N	N	N	Manufacturing						N	N	N	N	N	P	P	P	P	
N	N	N	N	N	N	Packaging and processing						N	N	N	E	P	P	P	P	P	
N	N	N	N	N	N	Product assembly/testing						N	N	N	E	P	P	P	P	P	
N	N	N	N	N	N	Research and development						E*	N	P*	E*	P*	P*	P	P	P	
N	N	N	N	N	N	Warehouse						N	N	N	C	C	P	P	P	P	
N	N	N	N	N	N	Wholesale distribution center						N	N	N	C	C	P	P	P	P	
RR1	RR2	RS	SFR	RG	RA	TRANSPORTATION						P	CR	DR	BC	C	BCI	IP	I	AI	
E	E	N	N	N	N	Airport/heliport						N	N	N	N	E	P	E	E	N	
N	N	N	N	N	N	Car wash/detailing						N	P	N	N	P	P	N	N	N	
N	N	N	E	N	N	Commercial parking garage or lot						E	P	C*	P	P	P	E	E	E	
N	N	N	N	N	N	Salt storage shed						N	E	N	E	E	P	P	P	P	
N	N	N	N	N	N	Taxi service						N	P	P	P	P	P	P	P	P	
E	E	E	E	E	E	Transit station						P	P	C	P	P	P	P	P	P	
N	N	N	N	N	N	Truck Rental Establishment						P	N	P	P	P	P	P	P	P	

P - Permitted, E - Special Exception, C - Conditional Use Permit, N - Not Permitted, * - Special provisions in district, see Article VII.

RR1-Rural Residential 1
RR2-Rural Residential 2
RS-Residential Single Family
SFR-Shorefront Residential
RG-Residential General

RA-Residential Apartment
P-Professional
BC-Business Central
BCI-Business Central Industrial
C-Commercial

DR-Downtown Riverfront
CR-Commercial Resort
IP-Industrial Park
I-Industrial
AI-Airport Industrial

NOTICE: The information provided herein is believed to be accurate, but Weeks Commercial, its salespersons and employees do not warrant or guarantee its accuracy in case of error or mistake. Therefore, it is recommended that all information be verified, and that the professional advice of an attorney and/or an accountant be sought before executing any contractual agreement.

ZONING

**Table I
Table of Permitted Uses
City of Laconia**

RR1	RR2	RS	SFR	RG	RA	TRANSPORTATION (continued)						P	CR	DR	BC	C	BCI	IP	I	AI	
N	N	N	N	N	N	Truck terminal						N	N	N	N	E	P	P	P	P	P
N	N	N	N	N	N	Vehicle dealership, sales and service						N	E	N	N	P	P	N	N	E	E
N	N	N	N	N	N	Vehicle major service						N	N	N	N	P	P	P	P	P	E
N	N	N	N	N	N	Vehicle fueling center/light service						N	C	N	C	C	P	N	N	N	N
N	N	N	N	N	N	Vehicle Rental Establishment						P	N	P	P	P	P	P	P	P	P
N	N	N	N	N	N	Vehicle salvage yard/wrecking						N	N	N	N	N	P	E	E	E	E
N	N	N	N	N	N	Vehicle storage, long-term						N	N	N	N	E	P	E	E	E	E
RR1	RR2	RS	SFR	RG	RA	GOVERNMENTAL AND PUBLIC SERVICES						P	CR	DR	BC	C	BCI	IP	I	AI	
E	E	E	E	N	N	Communications tower						N	E	N	N	N	E	E	E	E	P
C	C	C	C	C	C	Laconia municipal government uses or facilities						C	C	C	C	C	C	C	C	C	C
E	E	E	E	E	E	Power generation facility						E	E	E*	E	P	E	P	P	P	P
E	E	E	E	E	E	Utility						E	E	N	E	P	E	P	P	P	P
RR1	RR2	RS	SFR	RG	RA	LAND EXTENSIVE USES						P	CR	DR	BC	C	BCI	IP	I	AI	
P	P	N	N	N	N	Agriculture, including livestock						N	P	N	N	N	N	N	N	N	P
P	P	N	N	N	N	Agriculture/greenhouse, excluding livestock						N	P	N	N	N	N	N	P	P	P
E	E	E	E	E	E	Cemetery						E	E	N	N	N	N	N	N	N	N
E	N	N	N	N	N	Earth materials processing/sawmill						N	N	N	N	N	N	N	E	E	E

P - Permitted, E - Special Exception, C - Conditional Use Permit, N - Not Permitted, * - Special provisions in district, see Article VII.

RR1-Rural Residential 1
RR2-Rural Residential 2
RS-Residential Single Family
SFR-Shorefront Residential
RG-Residential General

RA-Residential Apartment
P-Professional
BC-Business Central
BCI-Business Central Industrial
C-Commercial

DR-Downtown Riverfront
CR-Commercial Resort
IP-Industrial Park
I-Industrial
AI-Airport Industrial

LACONIA CODE

**Table I
Table of Permitted Uses
City of Laconia**

RR1	RR2	RS	SFR	RG	RA	LAND EXTENSIVE USES (continued)						P	CR	DR	BC	C	BCI	IP	I	AI	
E	N	N	N	N	N	Excavation						N	N	N	N	N	N	N	E	E	E
P	P	P	N	N	N	Forestry						N	P	N	N	N	N	P	P	P	P
N	N	N	N	N	N	Junkyards						N	N	N	N	N	N	N	C	C	C
N	N	N	N	N	N	Landfill/resource recovery facility						N	N	N	N	N	N	N	C	C	C
RR1	RR2	RS	SFR	RG	RA	NONRESIDENTIAL ACCESSORY USES						P	CR	DR	BC	C	BCI	IP	I	AI	
N	N	N	N	N	N	Accessory docks						N	P	P	P	P	P	N	P	N	N
E	E	E	E	E	E	Building						P	P	P	P	P	P	P	P	P	P
P	P	P	P	P	P	Day care/nursery						P	P	P	P	P	P	P	P	P	P
N	N	N	E	N	N	Drive-through						E	P	N	E	P	E	P	P	P	P
N	N	N	N	N	N	Employee amenities						P	P	P	P	P	P	P	P	P	P
N	N	N	N	N	N	Outdoor storage						N	P	N	P	P	P	P	P	P	P
N	N	N	N	N	N	Retail outlet to industrial use						N	N	N	N	N	P	P	P	P	P
N	N	N	E	N	N	Take-out window						P	P	P	P	P	P	P	P	P	P
N	N	N	N	N	N	Storage containers						N	P*	N	N	P*	N	P*	P*	P*	P*
N	N	N	N	N	N	Storage trailers						N	N	N	N	N	N	P*	P*	P*	P*

P - Permitted, E - Special Exception, C - Conditional Use Permit, N - Not Permitted, * - Special provisions in district, see Article VII.

RR1-Rural Residential 1
RR2-Rural Residential 2
RS-Residential Single Family
SFR-Shorefront Residential
RG-Residential General

RA-Residential Apartment
P-Professional
BC-Business Central
BCI-Business Central Industrial
C-Commercial

DR-Downtown Riverfront
CR-Commercial Resort
IP-Industrial Park
I-Industrial
AI-Airport Industrial